



INSTALLATION INSTRUCTIONS

FOR USE ONLY WITH LOW VOLTAGE LANDSCAPE POWER UNITS THAT DO NOT EXCEED 25 AMPS, 15 VOLT MAXIMUM.

WARNING: Luminaires must be installed in accordance with the National Electrical Code (NEC) and local codes. Failure to do so will void the warranty and may result in serious injury and/or damage to the luminaire.

SAFETY WARNING: Luminaire can become very hot depending on lamp wattage used. Lens and metal around lamp can become hot enough to blister hands. Particular care should be taken not to locate luminaires where small children can reach them if high wattage lamps are used.

LUMINAIRES ARE NOT TO BE INSTALLED WITHIN 10 FT (3.05M) OF A POOL OR SPA. SECONDARY CABLE IS NOT TO BE BURIED MORE THAN 6". WHEN USING MULTIPLE LUMINAIRES, LOAD IS NOT TO EXCEED TOTAL WATTS OF TRANSFORMER RATING. DO NOT USE EXTENSION CORDS ON POWER UNITS.

NOTE: Always use UL recognized wire connectors for connections.

NOTE: Save these instructions for future reference; leave with property owner/manager.

LUMINAIRE MOUNTING:

CAUTION: NOT FOR USE IN SWIMMING POOL OR SPA APPLICATIONS.

1. To prevent electrical shock, disconnect transformer from electrical supply before installation or service.

NOTE: DO NOT pull underwater cable. If wire is pulled, it may break the liquid tight seal and void the warranty.

NOTE: DO NOT loosen or remove liquid-tight connector. This will damage the factory set seal and result in possible leakage.

NOTE: End of underwater cable must be potted to prevent moisture from entering cable and consequently entering luminaire. Connection or splicing of cable must be made above water line and at least 4' from water edge. This luminaire comes equipped with 15' of waterproof cable to facilitate installation away from water.

NOTE: Each luminaire is factory tested prior to shipment. Traces of water may be visible as a direct result of factory underwater testing.

2. Strip the two leads from the luminaire pigtail. Using two safety connectors (provided), connect leads from luminaire to main supply cable leads.

NOTE: Luminaires are supplied with 15' of 18-2 cable pigtail for secure connection to main supply cable.

3. Provide power to luminaire and check for proper operation.

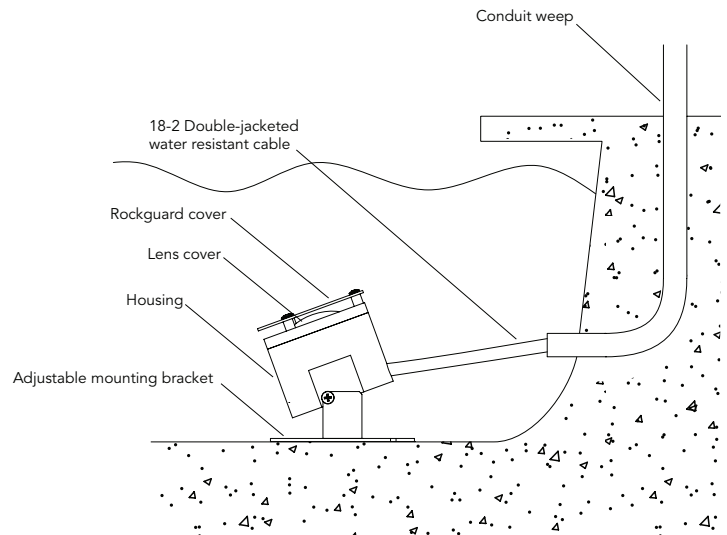

The operating voltage range for this LED luminaire is 6 - 15 volt AC. The Vista electronic driver ensures the LED operates at the intended lumen output while receiving voltage as low as 6 volts, and as high as 15 VAC, resulting in a balanced lumen output from the first fixture to the last. Eliminating the dimness issues often attributed to voltage drop.

Note: Operating voltage range for LED luminaires will vary depending on model, style and total number of LEDs. To help determine the operating voltage range for each Vista luminaire, always consult factory's specification sheet and/or installation instructions before installation.

LED ENGINE INSTALLATION/REPLACEMENT:

1. To prevent electrical shock, disconnect transformer from electrical supply before service.

2. Remove fixture from water and allow to dry.

3. Remove stainless steel screws from bottom of fixture.

4. Remove fixture cover and lens.

5. Remove stainless steel locking/expansion ring.

6. Pull up field replaceable LED engine assembly out of fixture base.

7. Disconnect connector assembly.

8. Connect new field replaceable LED engine to connector assembly.

9. Re-install LED engine assembly into fixture base and secure with stainless steel locking/expansion ring.

10. Re-install lens and cover taking care to assure proper seating of the silicone O-ring.

11. Tighten stainless steel screws.

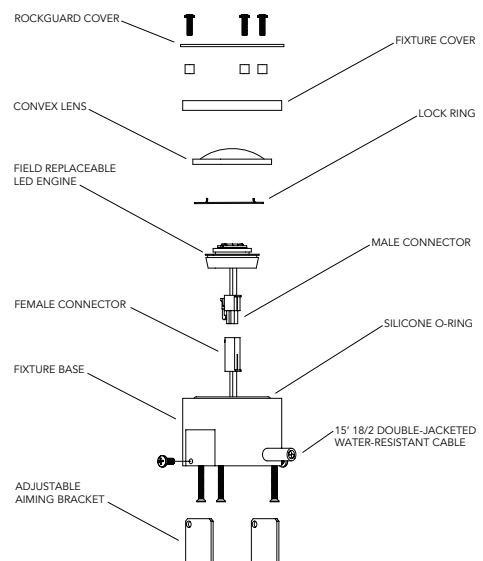

Vista Professional Outdoor Lighting reserves the right to modify the design and/or construction of the fixture shown without further notification.