



FOR USE ONLY WITH LOW VOLTAGE LANDSCAPE POWER UNITS THAT DO NOT EXCEED 25 AMPS, 15 VOLT MAXIMUM

IMPORTANT NOTE:

Luminaire must be installed and grounded in accordance with the National Electrical Code (NEC) and local codes.

Luminaire is UL listed for above grade installation only.

Always use UL recognized wire connectors for connections.

MAINTENANCE: To assure proper operation and efficiency and to prevent luminaire overheating, lens must be kept clean and free of dirt, dust, leaves, trash and mineral deposits from water. A regular schedule maintenance program is recommended.

SAFETY WARNING: Luminaire can become very hot depending on the lamp wattage used. Lens and housing around the lamp can become hot enough to blister hands. Particular care should be taken not to locate luminaires where small children can reach them if high wattage lamps are used.

LUMINAIRES ARE NOT TO BE INSTALLED WITHIN 10 FT. (3.05M) OF A POOL OR SPA. SECONDARY CABLE IS NOT TO BE BURIED MORE THAN 6". WHEN USING MULTIPLE LUMINAIRES, LOAD IS NOT TO EXCEED THE TOTAL WATTS OF TRANSFORMER RATING. DO NOT USE EXTENSION CORDS ON POWER UNITS.



LUMINAIRE MOUNTING

1. To prevent electrical shock, disconnect transformer from electrical supply before installation or service.
2. Run wire pigtail from luminaire through mounting hole in top of ground stake.
3. Thread luminaire into threaded hole in ground stake.
4. Place stake in desired position and insert into ground until flange of stake is flush to grade.
5. Strip two leads from luminaire pigtail. Using two silicone filled safety connectors (provided), connect leads from luminaire to main supply cable leads.

NOTE: Luminaires are supplied with 36" of 18-2 cable pigtail for secure connection to main supply cable. Wire is to be protected by routing in close proximity to luminaire. Wiring should be buried a maximum depth of 6 inches in order to connect to main supply cable.

6. Provide power to luminaire and check for proper operation.

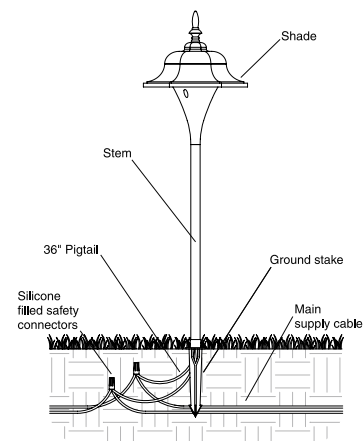

WARNING: TO REDUCE THE RISK OF FIRE, OR INJURY TO PERSONS:

1. Turn off/unplug and allow to cool before replacing lamp.
2. Lamps get hot quickly! Contact only switch/plug when turning on.
3. Do not touch hot lens, guard or enclosure.

4. Keep lamp away from material that may burn.

5. Do not operate luminaire fitting with a missing or damaged cover.

SAVE THESE INSTRUCTIONS (leave with property owner/manager)

LED LAMP INSTALLATION/REPLACEMENT:

CAUTION: Do not exceed maximum wattage marked on luminaire label.

1. To prevent electrical shock, disconnect transformer from electrical supply before installation or service.
2. Rotate shade to unlock position.
3. Remove shade and lens to expose lamp.
4. Replace lamp with correct wattage and type marked on fixture label.
5. Re-install shade and lens.
6. Rotate shade & lens to lock position.

NOTE: LED lamps must be protected from moisture and dust at all times. Always re-install shade and lens when moved.

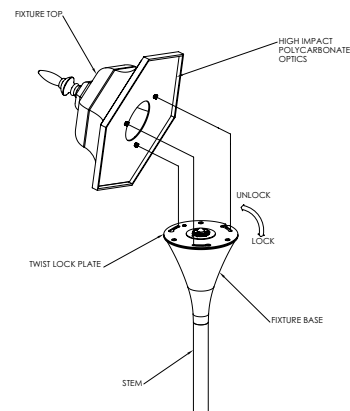

CAUTION: USE ONLY ON 9 - 15 VOLT CIRCUITS.

Do not unnecessarily over-voltage LED lamps. For optimal performance and maximum efficiency always operate LED lamps as close to 12 volts as possible. Never exceed maximum operating voltage. Failure to do so will void the warranty and may result in serious damage to lamp and luminaire. Dimming function may not be compatible with all dimmers, please consult factory technical department for up-to-date compatible dimmer information.

