

**SOUND**  
BY VISTA

# **SBV-2-50 Amplifier & Weatherproof Enclosure Kit**

**Hi-Fi Landscape Audio System**



*Installation Manual*

**VistaPro.com/Sound**

# Introduction

Thank you for your purchase of the *Sound by Vista SBV-2-50 Amplifier & Weatherproof Enclosure Kit*. These components were expertly paired to work with the SBV-10-4 Audio System and provide an excellent listening experience. Please do not attempt to connect them to any other system.



## WEATHERPROOF ENCLOSURE

- UV stable and highly corrosion resistant
- NEMA 3R, 3RX/IP24 rated
- Thermostat controlled cooling fan
- Fiberglass reinforced polyester (FRP)
- RF transparent enclosure
- Stainless steel hinge and quick release latches with padlock hasps
- Two (2) 4" vents with rain shields and screens
- Tamper resistant screw and key combo for added security
- Two-year limited warranty



## AMPLIFIER

- VSSL A.1 Home
- Output power: 35 watts @ 8  $\Omega$  RMS, 50 watts @ 4  $\Omega$  RMS
- Wi-Fi & Bluetooth compatibility
- Native Streaming™: Built-in Chromecast, Apple AirPlay 2 and Spotify Connect
- Compatible with iOS, Android, Mac and PC devices
- Voice controls using Google Assistant and Siri Assistant devices
- One-year limited warranty

# Assembly Recommendations

**Materials:** Sound by Vista enclosure, amplifier, amplifier mounting bracket and mounting screws.



## INSTRUCTIONS

1. Open the enclosure and remove the top two screws.
2. Install the amplifier mounting bracket, as shown, using the longer screws included with the bracket. Do not overtighten the screws.
3. Mount the amplifier to the amplifier mounting bracket by aligning the bracket's screws to the cross-pattern mount on the bottom of the amplifier. Make sure the LED indicator is on the top of the enclosure and the connection set is to the bottom.

4. Please refer to the VSSL A.1 Product Guide for additional installation instructions.

<https://vssl.com/wp-content/uploads/2020/07/VSSL-A.1-Product-Manual-1.pdf>

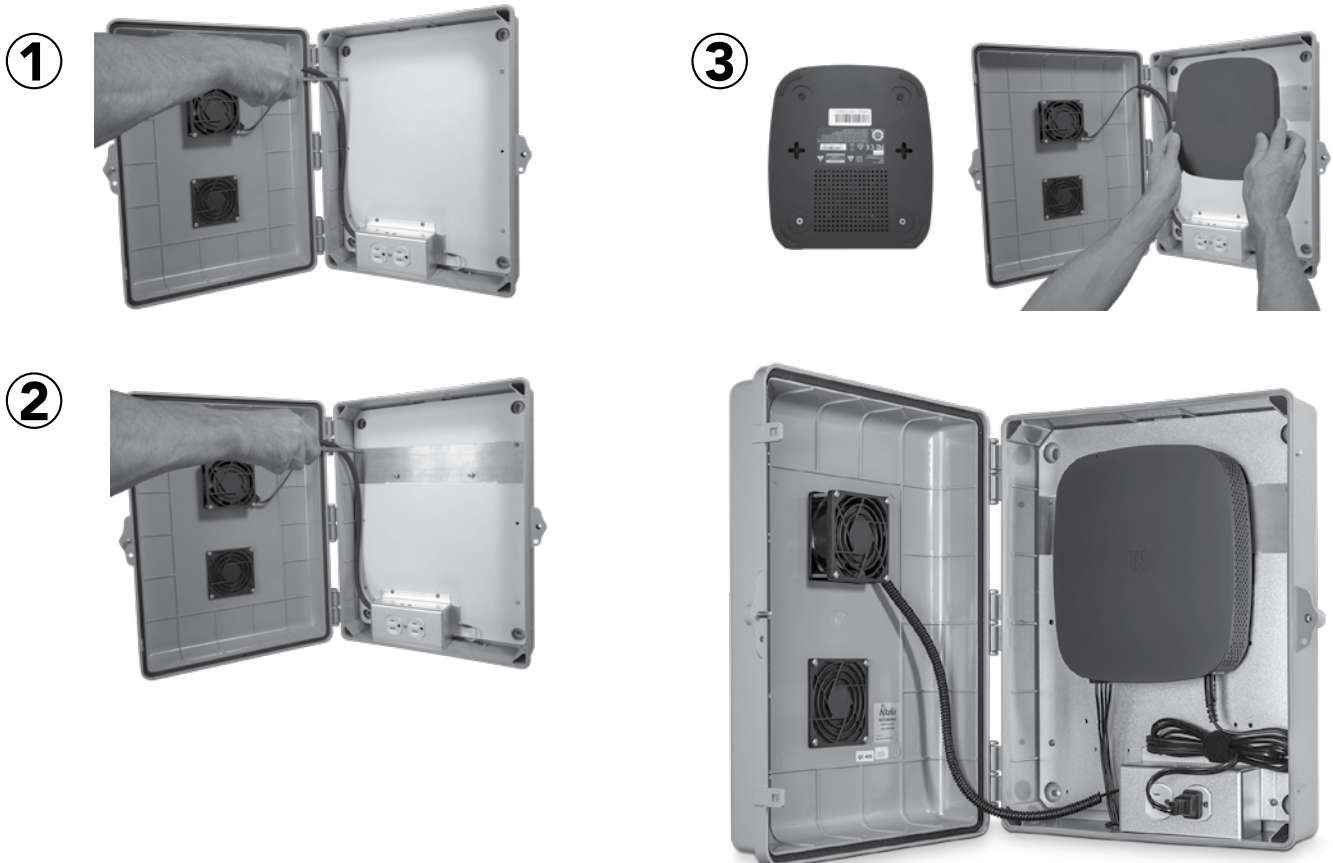

# Technical Assistance

If you have any trouble with the installation or have any technical questions, please email us at [soundbyvista.support@vistapro.com](mailto:soundbyvista.support@vistapro.com) or call us at (805) 395-9120.

## Warranty

### LIMITED WARRANTY

---

Vista warrants that its amplifiers and enclosures are free from defects in workmanship and materials only when purchased through an authorized Vista distributor.

At Vista's exclusive discretion, replacement or repair of authorized returned items, found to be defective upon inspection within the warranty period, shall constitute fulfillment of all Vista obligations under its warranties. Warranties for amplifiers and enclosures are covered as stated in their respective manufacturer's warranties. Enclosures are two (2) years and amplifiers are one (1) year. All warranty periods commence on date of shipment; all conditions of installation and operation must have been complied with, or all applicable warranties are void. Vista assumes no responsibility for the improper installation of its products or for labor costs involved in repair or replacement.

No other warranties or guarantees, either expressed or implied, exist beyond the stated warranties herein. No employee or agent of Vista may extend, modify and/or change the terms of these warranties. Under no conditions will Vista be liable for any incidental, consequential, special or money damages in connection with any breach of its aforementioned warranties.

### Merchandise Returns

No speakers, subwoofers, amplifiers, enclosures or accessories may be returned by a customer without a prior written authorization in the form of a Return Goods Authorization (RGA), which has been issued by Vista's Customer Service Department. RGA's will be issued at the sole discretion of Vista and must be requested within sixty (60) days of shipment. Unless product is defective, all merchandise must be returned in its original sealed carton in saleable condition. Except for merchandise that is determined to be defective by Vista, all returns are subject to a 35% handling and restocking fee. All returned merchandise, defective or otherwise, must be shipped prepaid to the Vista factory. All outdated and/or discontinued speakers, subwoofers, amplifiers, enclosures and/or accessories are not returnable.

***Thank you for your purchase.***