

2117-BSN

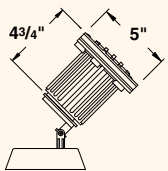

Brass
50 W max (halogen)
MR-16 Lamp or LED
LN-20 BAB/FG Std



2117-BSO



Brass
50 W max (halogen)
MR-16 Lamp or LED
LN-20 BAB/FG Std

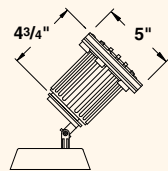

2117

HOUSING	
» Injection-molded, reinforced polymer	
» Exceptional strength and UV stability	
LENS COVER	
» Solid Brass	
» CNC Machined	
» Brass available with an Olde Brass finish	
» Silicone O-ring gasket	
» Superior weather-tight seal	
FINISH	
» Lens cover available in Natural Brass or Olde Brass	
SOCKET/LAMP HOLDER	
» Proprietary ceramic socket	» Stainless steel springs
» Nickel contacts	» Teflon-jacketed wire leads
LENS	
» Convex	» Shock- and heat-resistant
» Clear	» Soda-lime glass
» Tempered	» For optical effect lenses, see ordering information.
OPTICS/AIMING	
» Adjustable and lockable lamp bracket	
» ±25° of tilt	

2117

LAMP TYPE	
» Standard lamp included with fixture. For other lamp and wattage options see Lamp Guide, pages 128-130.	
PHOTOMETRICS	
» For photometric data, see pages 131-149.	
MOUNTING	
» Adjustable mounting bracket	» Cement counterweight base
FASTENERS	
» Stainless steel fasteners	
WIRING	
» Prewired with a fifteen-foot pigtail of 18-3 cable	» Water resistant
» Double-jacketed	» Above water connectors

2114 / 2117 / 2118 / 2119

HOUSING	
» Solid Brass or stainless steel	» CNC Machined
FINISH	
» Natural Brass or Stainless Steel	
SOCKET/LAMP HOLDER	
» Top grade ceramic socket	» Stainless steel springs
» Nickel contacts	» Teflon-jacketed wire leads
LED	
» High output emitters	
» Powered to operate for 50,000 hours	
» Vista exclusive smart driver	
LENS	
» Clear	» Soda-lime glass
» Tempered	» Impact-resistant diffuser attached
» Shock- and heat-resistant	

ELECTRICAL	
» Input voltage range 10-15 VAC	
» Regulated for uniform illumination throughout the cable run of fixtures	
» Integral surge and reverse polarity protection	
OPTICS/AIMING 2115 and 2119 only	
» Adjustable and lockable lamp bracket	
» ±25° of tilt	

LAMP TYPE	
» Standard lamp included with fixture. For other lamp and wattage options see Lamp Guide, pages 128-130.	

PHOTOMETRICS	
» For photometric data, see pages 131-149.	

MOUNTING	
» Adjustable mounting bracket	

FASTENERS	
» Stainless steel fasteners	

WIRING	
» Prewired with a fifteen-foot pigtail of 18-3 cable	» Water resistant
» Double-jacketed	» Above water connectors

CAUTION: Follow installation instructions as well as local electrical codes when installing underwater fixtures. Underwater fixtures are **NOT** for use in swimming pools or spas.

2114-BSN



Brass
5 W
LED

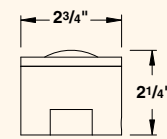

2115-BSN



Brass
5 W
LED

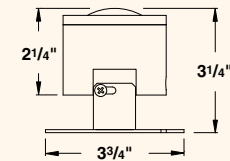

2118-BSN



Brass
5 W
LED

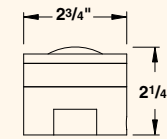

2119-BSN



Brass
5 W
LED

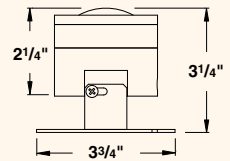

LED SPECIFICATIONS Look for this mark on products where LED options are available.

LED Lamp High Output Plug-in LED lamp with Vista exclusive smart-driver, powered to operate for 30,000 hours with an operating voltage of 9-15 VAC. See page 128 for extended specifications and options.	Integrated LED High Output LED lamp assembly with Vista exclusive smart-driver, powered to operate for 50,000 hours with an operating voltage of 9-15 VAC. See page 130 for extended specifications and options.
---	--

ORDERING INFORMATION Select appropriate choice from each column **example: UW-2117-BSN-BAB/FG-BL**

Mounting	No.	Finish	Lamp	Lenses/Accessories
UW Underwater	2117	BSN Natural Brass BSO Natural Brass w/Olde Brass finish	See reference codes, pages 128-130	BL Flat Cool Blue Lens SL Flat Spread Lens FR Flat Frosted Lens CX Convex Clear Lens CFR Convex Frosted Lens DBL Flat Dark Blue Lens GL Flat Dark Green Lens RL Flat Red Lens YL Flat Amber Lens HL Honeycomb Louver
	2114 2115 2118 2119	BSN Natural Brass SS Stainless Steel	INTEGRATED LED Reference codes page 130: 2114, 2115: group B 2118, 2119: group C	

NOTE: not all accessories are available for all fixtures. See footnotes below before ordering. Fixtures shipped with standard lamp, unless otherwise specified, and with specified mounting hardware.

